

GENERAL NOTES:

- A. ELECTRICAL DRAWINGS ARE DIAGRAMMATICAL AND MAY NOT ACCURATELY REFLECT ACTUAL CONSTRUCTION CONDITIONS. THE ELECTRICAL CONTRACTOR SHALL BE RESPONSIBLE FOR COORDINATING THE INSTALLATION OF ALL ELECTRICAL EQUIPMENT, WITH ALL TRADES PRIOR TO AND DURING CONSTRUCTION.
- B. LIGHTING AND RECEPTACLES IN THE RETAIL LEASE SPACES SHALL BE PROVIDED WITH TEMPORARY CIRCUITS FROM THE HOUSE BRANCH PANELS AS INDICATED ON THE PLANS. AT SUCH TIME THAT EACH SPACE IS LEASED AND BUILT TO SUIT THE TENANT, THE TEMPORARY POWER CIRCUITS SHALL BE DISCONNECTED AND REMOVED, WITH THE BREAKERS NOTED AS "SPARE".
- C. THE ELECTRICAL CONTRACTOR SHALL REFER TO THE ARCHITECTURAL DRAWINGS FOR ALL MOUNTING HEIGHTS AND FINISHES OF DEVICES AND FIXTURES.
- △ D. LOBBY LIGHTING TO BE HUNG AT VARYING HEIGHTS (BETWEEN 12'-0" AFF AND 8'-0" AFF) WITH FIXTURE OVERLAPPING. CONTRACTOR SHALL CONSULT WITH THE INTERIOR DESIGNER AND/OR ARCHITECT PRIOR TO ROUGH IN.
- E. REFER TO E400 SERIES SHEETS FOR TYPICAL APARTMENT UNIT POWER AND LIGHTING LAYOUT.
- F. REFER TO E1.21 FOR LUMINAIRE SCHEDULE.

△ LIGHTING DESIGN NOTES:

1. THE CONTRACTOR SHALL CONSULT THE ARCHITECT AND INTERIOR DESIGNER FOR ALL FIXTURE LOCATIONS PRIOR TO THE START OF ANY ROUGH IN WORK
2. ALL CORRIDOR AND LOBBY LINEAR LIGHT FIXTURES ARE LAID OUT TO PRODUCE A RANDOM PATTERN EFFECT.
3. THE LINEAR FIXTURES LOCATED IN THE FIRST FLOOR LOBBY SHALL BE CABLE HUNG AT VARYING HEIGHTS, AS DIRECTED BY THE INTERIOR DESIGNER. SPACING OF THE FIXTURES SHALL BE SUCH TO PROVIDE ADEQUATE LIGHT LEVELS AND REDUCE POTENTIAL FOR CREATING DARK SHADOWS.
4. THE LINEAR FIXTURES LOCATED IN THE UPPER LEVEL CORRIDORS SHALL BE SURFACE MOUNTED IN A RANDOM PATTERN, AS DIRECTED BY THE INTERIOR DESIGNER. SPACING OF THE FIXTURES SHALL BE SUCH TO PROVIDE ADEQUATE LIGHT LEVELS AND REDUCE POTENTIAL FOR CREATING DARK SHADOWS.
5. REFER TO AVAILABLE ARCHITECTURAL AND/OR INTERIOR DESIGN DOCUMENTS & DRAWINGS FOR ADDITIONAL INFORMATION.

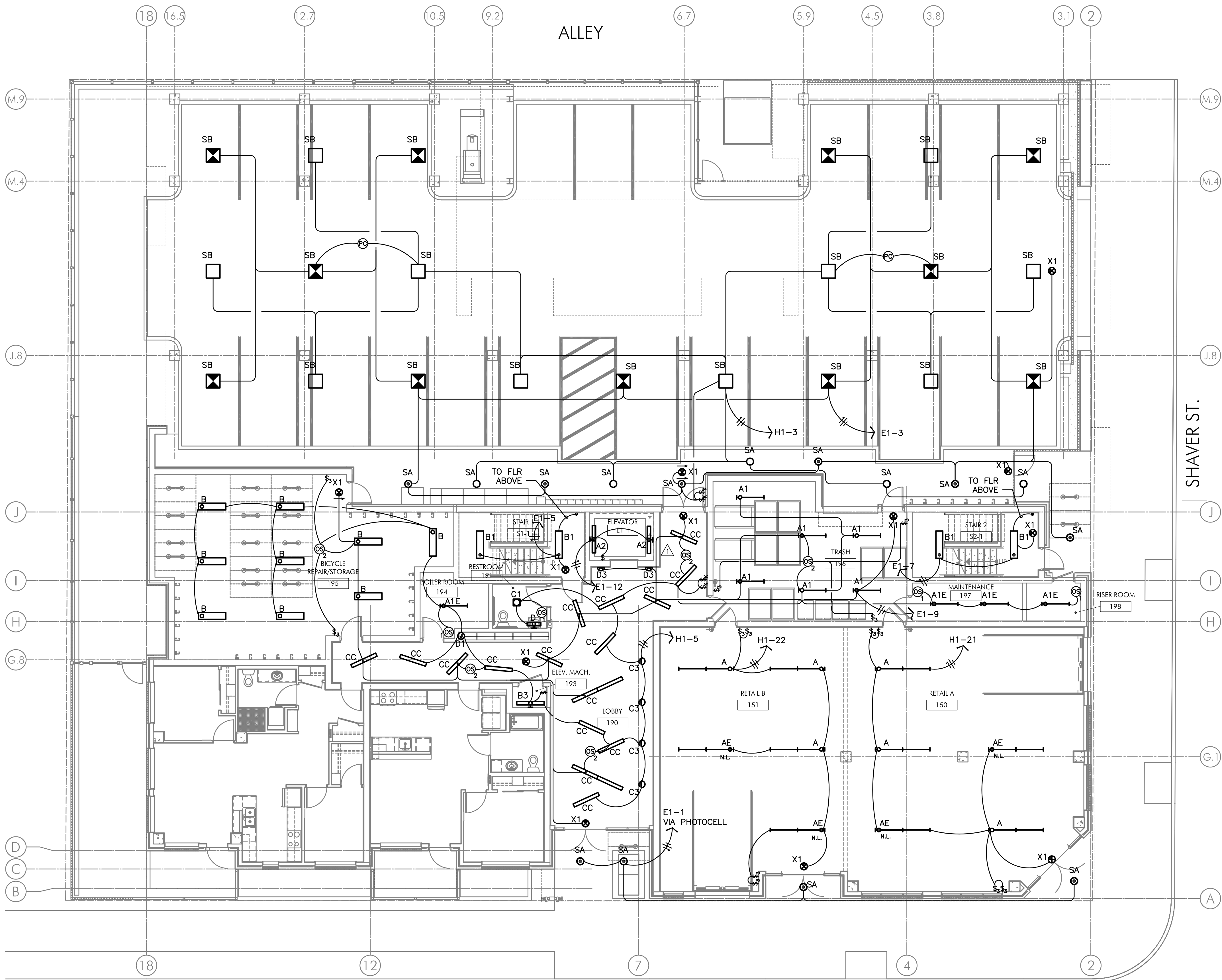

VANCOUVER AVE.

1 FIRST FLOOR LIGHTING PLAN
E2.01 SCALE: 1/8" = 1'-0"